



OUR SPARK PRE FAB INSULATED CONTAINER SIZES, PRICES AND LAYOUTS FOR RENT

Comes in Two Sizes

Size: 3000x5900*2700mm Size: 17.70 SQM

Size: 3000x11900*2700mm sizes:.35.70 SQM



7/02/2018



ONE QUEEN CONTAINER 3000*5900=17.70sqm
Bigger than a 20+ Foot Model
ONE OPEN LOUNGE

\$175 + GST PER WEEK RENT

Suitable for Office, Bedroom, Extra room space
Enclosures List

Container: Fully Insulated pre painted mist white.

Rooms: One large Room

Floor Plan: Open Lounge/Studio/Office

Floor: Steel Kit , with timber floor and vinyl covering

Walls & Roof Insulated EPS Panels

Doors: 1 Double Glazed Sliding Glass Door

Windows: Two Double Glazed Sliding Windows.

Electrical: Three lights and three Power Points, just need to plug into main lines and connect.

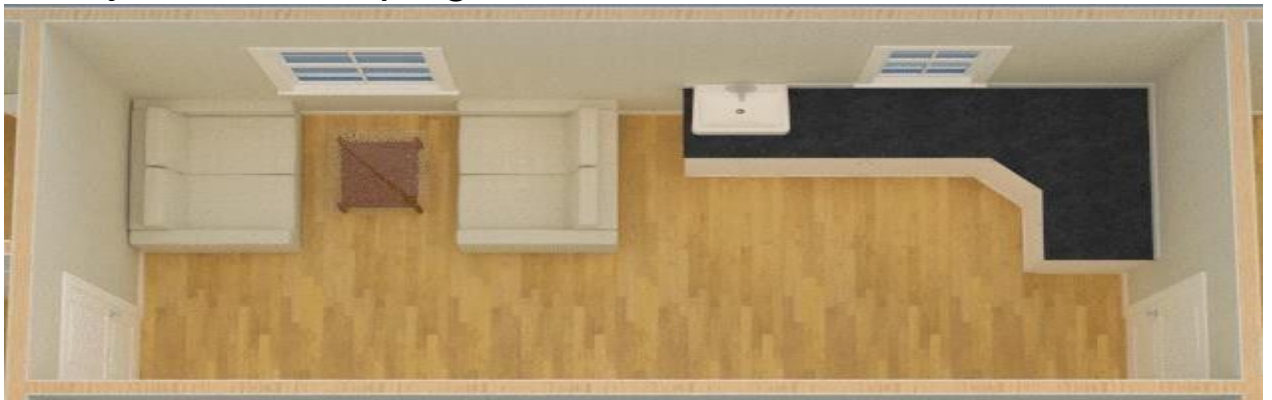

Down payment: \$2,000

Rent To Own: 5 Yrs 1 \$153+GST 3 Yrs 191 +GST Per Week

Subject to Approval, These price can change depending on your credit score.

7/02/2018

2



ONE QUEEN - B CONTAINER 3000*5900=17.70sqm
Bigger than a 20+ Foot Model
ONE OPEN LOUNGE /BEDROOM/KITCHEN

\$250 + GST PER WEEK RENT

**Suitable for Office, Bedroom, Extra room
space Self Contained**

Container: Fully Insulated pre painted mist white.

Rooms: 1 Studio/Lounge/Bedroom

Bathroom, 1 Toilet, 1 Shower, 1 Vanity

Floor Plan: Open Lounge with bedroom

Floor: Steel Kit, with timber floor and vinyl covering

Walls & Roof EPS Insulated Panels

Doors: 1 Double Glazed Sliding Glass Door

Windows: Two Double Glazed Sliding Windows.

Electrical: Three lights and three Power Points,
just need to plug into main lines and connect.



Down payment: \$2,600 +gst

Rent To Own: 5 Yrs 1 \$170+ GST, 3 Yrs 220 +GST Per Week

Subject to Approval, These price can change depending on your credit score.

7/02/2018

3



**ONE KING CONTAINER 3000*11900=37.70sqm
FULLY INSULATED ONE OPEN LOUNGE**

\$350 + GST PER WEEK RENT

**Suitable for Office, Bedroom, Extra room space
Enclosures**

Container: Fully Insulated pre painted mist white.

Rooms: One Large Room

Floor Plan: Open Lounge/Office/Studio

Floor: Steel Kit , with timber floor and vinyl covering

Walls & Roof Insulated EPS Panels

Doors: 1 Double Glazed Sliding Glass Door

Windows: Three Double Glazed Sliding Windows.

Electrical: Four lights and four Power Points, just need to plug into main lines and connect.



Down payment: \$3,000 +GST

Rent To Own: 5 Yrs 1 \$290+ GST, 3 Yrs 353 +GST Per Week

Subject to Approval, These price can change depending on your credit score.



**ONE KING – 1BT1BK CONTAINER 3000*11900=37.70sqm
FULLY INSULATED TRANSPORTABLE**

**1 BEDROOM + LOUNGE + KITCHEN + BATHROOM
\$420 + GST PER WEEK RENT**

Suitable for Accommodation Self Contained

Container: Fully Insulated pre painted mist white.

Rooms: One large room

Bathroom: 1 Toilet, 1 Shower, 1 Vanity

Floor Plan: Open Lounge, Bathroom, Kitchen.

Floor: Steel Kit , with timber floor and vinyl covering

Walls & Roof Insulated EPS Panels

Doors: 1 Double Glazed Sliding Glass Door

Windows: Three Double Glazed Sliding Windows.

Electrical: Four lights and Four Power Points, just need to plug into main lines and connect.



Down payment: \$3,600 + Gst

Rent To Own: 5 Yrs 1 \$325+ GST, 3 Yrs 380 +GST Per Week

Subject to Approval, These price can change depending on your credit score.

7/02/2018



**ONE KING – 1BT2BK CONTAINER 3000*11900=37.70sqm
FULLY INSULATED TRANSPORTABLE**

**TWO BEDROOM + LOUNGE + BATHROOM + KITCHEN
\$480 + GST Per Week Rent**

Self Contained, Enclosures

Container: Fully Insulated pre painted mist white.

Bed room: As required

Floor Plan: Two Bedrooms, Lounge, Bathroom

Bathroom: 1 Toilet, 1 Shower, 1 Vanity

Floor: Steel Kit , with timber floor and vinyl covering

Walls & Roof EPS Insulated Panels

Doors: 1 Double Glazed entrance door with lock,

Windows : 4 Double Glazed windows with locks and fly screen.

Electrical: 4 lights and four power Points



Down payment: \$4,400 + Gst

Rent To Own: 5 Yrs 1 \$360+ GST, 3 Yrs 450 +GST Per Week

Subject to Approval, These price can change depending on your credit score.

7/02/2018



**ONE KING – 1BT3BK CONTAINER 3000*11900=37.70sqm
FULLY INSULATED TRANSPORTABLE**

**THREE BEDROOM + LOUNG + BATHROOM
\$530 + GST PER WEEK RENT**

**Suitable, for, Extra room space Self Contained,
Enclosures**

Container: Fully Insulated pre painted mist white.

Bed room: As required

Floor Plan: Three Bedrooms

Bathroom: 1 Toilet, 1 Shower, 1 Vanity

Floor: Steel Kit , with timber floor and vinyl covering

Walls & Roof EPS Insulated Panels

Doors: 1 Double Glazed entrance door with lock,

Windows : 4 Double Glazed windows with locks and fly screen.

Electrical: Five lights and four power points



Down payment: \$5,200 + Gst

Rent To Own: 5 Yrs 1 \$390+ GST, 3 Yrs 520 +GST Per Week

Subject to Approval, These price can change depending on your credit score.



FAQ

Find Answers To All Your Questions

Are these fully insulated?

Yes, all our SPARK homes cabins are highly insulated to 7 Star Rating

What areas do SPARK homes Cabins service?

We pretty much cover all of Australia and we'll do our best to get a cabin to you no matter where you are.

What sizes are SPARK homes Cabins ?

We have three different sizes of cabin, with the following dimensions:

- *Standard cabin is 5.9m long x 3m wide*
- *Large size cabin is 11.9m long x 3m wide*
- *Two or more Container Cabins put together.*

Can we put two or more SPARK homes Cabins together?

Yes, we can design two or three cabins to give any that extra accommodation space.

How high do I need the access to be for SPARK homes Cabins ?

You will need a 3.3m height clearance (from trees or house eaves).

How wide do I need the access to be SPARK homes Cabins?

Entry access should be 3.5m wide so the cabin can be towed onto your site.

What if access is too narrow?

A hi-ab or a crane can lift our cabin over most obstacles (carports, fences, retaining walls etc.) Also overhead electricity and phone lines need to be taken into consideration before arranging transportation.

How much room will I need?

You will need approximately 6m x 3m for our small cabins and 12m*3m for our bigger cabins on reasonably level ground.

Are they painted?

Yes, cabins come fully painted inside and out.

7/02/2018



How are they heated and cooled?

Keeps warm in winter and cold in summer as they are designed to be highly energy efficient with a small cooler or heater

What colours are they?

All cabins come in neutral shades (like surfmist,) which looks great

Do you provide option for exterior cladding if required?

Yes we do have options for various types of cladding as an add on, at a cost.. .

Will we need a building consent?

As our cabins are transportable, they do not come under the Building Act. Therefore you shouldn't need a building consent. Furthermore, the Department of Building and Housing regulations do not require a building consent if your building does not exceed one story and does not exceed 20 square metres in floor area, and does not contain cooking or sanitary facilities or a potable water supply. However, if you are unsure, please contact your local council for clarification.

Is a bond required?

Yes. The bond varies depending on the size cabin you choose. Please enquire at the time of hiring, At the end of the hire when the cabin is returned in excellent condition your bond will be refunded.

Do you deliver the cabins?

Yes, we deliver the cabins to you at a fee. We will set your cabin up level on your site on piers that is pre installed by you. If you want your cabin shifted (e.g. if you're moving house) we will do this for a small fee.

What about Set up?

Set-up is not included in the price. We can advise you, what will be required in terms of levelling, running services, etc. We can also discuss the various options for installing/securing the unit. You can then begin this work while we are constructing your container dwelling.

Do you offer solar Power?

Yes we do at a cost, we are currently working with a solar company and can easily tailor the units to be "solar ready". We can also work with them to deliver a full or partial off-grid quote specific to your situation.

7/02/2018



If we do not have a land, can we still rent them?

Yes you can, when looking at residing in the SPARK Home cabins and you do not yet own land, is to contact a local mobile home park and discuss placing your container home in the park. The advantage to this option is that all utility services are already present.

What could I fit inside a Spark homes Cabins?

You could fit one or more office desks, filing cabinets or a single, double or queen-sized bed, chest of drawers, and other furniture. Choose from two cabin sizes.

Is there an option to add on other items that is not included in the standard enclosures?

Yes you can, please ask and we can give you an estimation.

Is there a minimum rental period?

Minimum six months. However, please ask.

What do I do when I'm finished with my Cabin?

As long as you've completed your minimum rental period you only need to give one calendar months written notice to remove your cabin at a cost.

Is there a collection fee?

Yes depending on the location you are at a fee.

Do I get my bond back?

Provided you have returned your cabin in a clean and undamaged condition, we will refund you your bond.

When can you deliver one to me?

We can usually deliver within days. Please call 02 88074717 to confirm availability.

How do I order a cabin?

You can order your cabin online – By sending us an email with your requirement and we will then send you our Rental application form. Select where you want the cabin delivered, then complete your details and send back to us. We will contact you to confirm the delivery time & date. It's that simple.

How thick is a container? How are they constructed?

They are made of strong chassis steel frames and a min of 50mm insulated panels.

7/02/2018



Can I avail a transportable home on finance?

Yes, we do have this option as well.

Are these prices fixed ?

No, Prices can change without notice.

What can I use my SPARK Homes Cabin for?

Looking for more living or office space? Need to rent a room? Spark homes have the easy and affordable solution for you. Portable cabins rental, supplying you with a single portable room that's versatile, functional and practical - the perfect answer when you need extra room. Available to rent in three convenient sizes, these qualityconstructed

SPARK Homes, portable cabins can enhance your home or business as a:

Extra bedroom, sleepouts, storage, farm workers room, Holiday Park Cabins, Studio, Home Office, Rumpus room, Guest Room, Site or Sales Office, Portable Office, Caravan alternative, Mining Accommodation Extra Bedroom.

PLEASE NOTE IMAGES USED ARE JUST FOR ILLUSTRATION PURPOSE